

972560H

質量
APPROX.MASS : 38 kg

41(最大)
41(MAXIMUM)

7
4.7^{+0.25}₀
1x45°

1
30°
46.7
φ55 H7
φ210 h7
φ254.5
φ255 h7

0.2
A
φ100

18-φ13
φ275
20°

φ136
φ177
120°

13°
13°
18°
9°
9°
13°
13°
13°
13°

2-M12(抜きタップ)
(FORCING TAP)
28
B-B

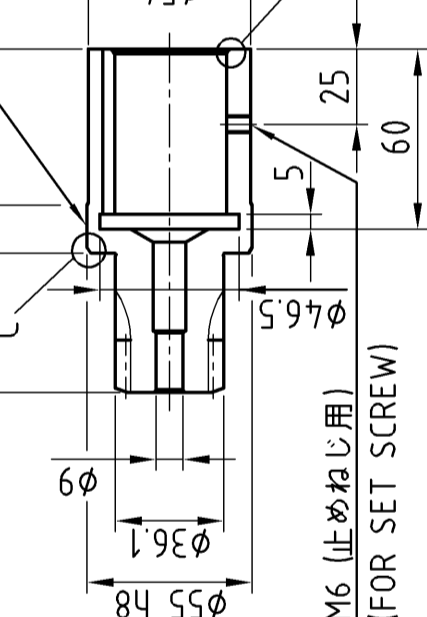
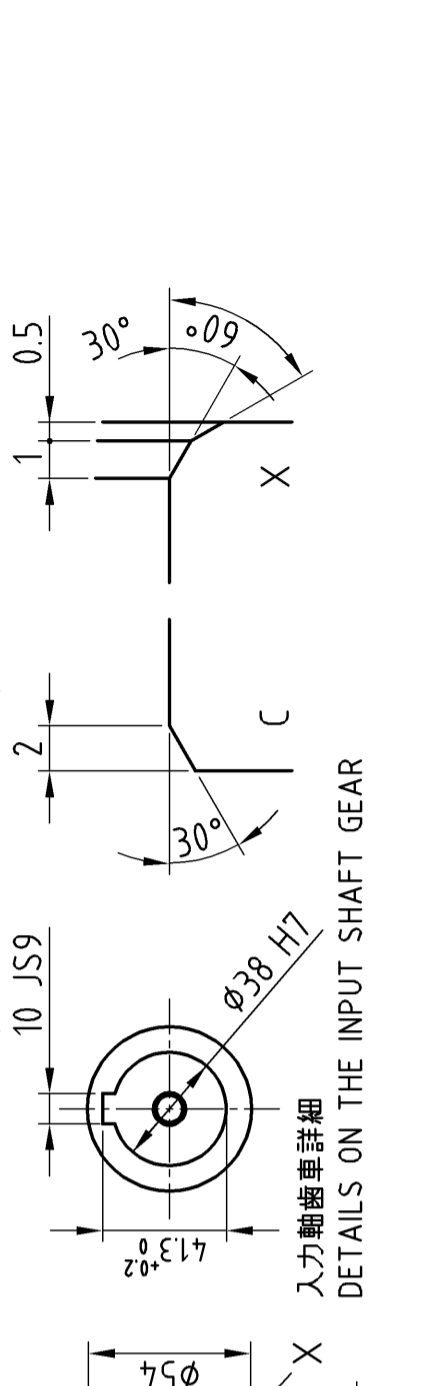
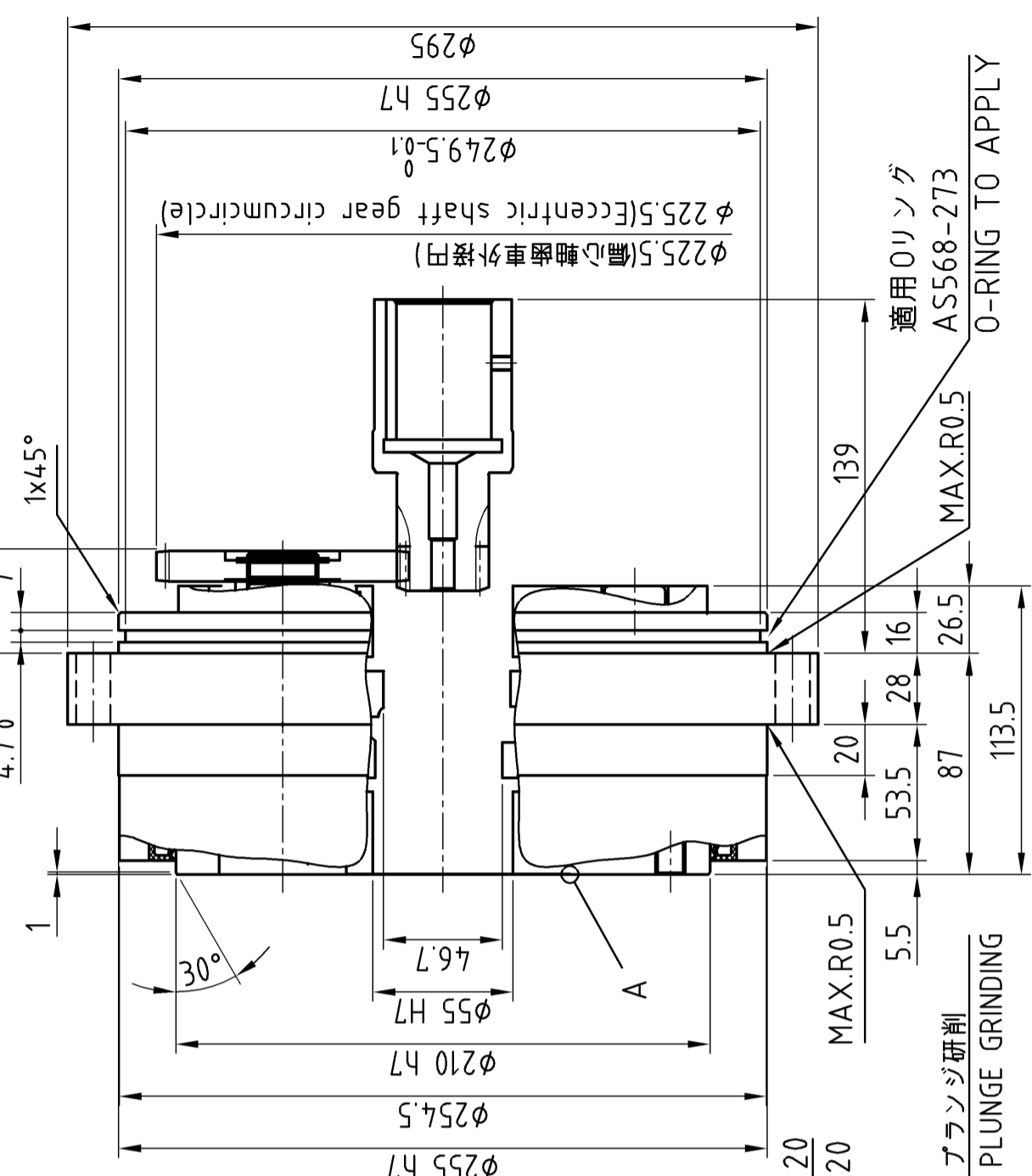

注意事項：
取付用のボルト、座金、液状パッキン、Oリング及び潤滑用グリースは
お客様にて御用意下さい。

Precautions:
Prepare bolts for mounting, washers, liquid gasket, O-ring,
and grease for lubrication by customers.

CUSTOMER	WORK.NO.	ITEM.NO.	USE ORDER NO.	Q'TY SET	SHI MANUF.NO.
X04502G					
SCALE	Y.Miura	H.Endo	DATE	F2CF -UA65-171	
			INSP.	CYCLO DRIVE	
			APPR.	OUTLINE DRAWING	
				DRAW. NO. IF Q 9 5 2 4 G I	
REV.				Sumitomo Drive Technologies ◆ Sumitomo Heavy Industries, Ltd.	